

6.6 A Current Controlled Halogen - Pk30d Base Lamps for Series Operation

High quality single end lamps with specially designed Pk30d base for optimal thermal performance

Areas of application

- Airfield Lighting



Product features and benefits

- Low maintenance costs due to long lamp life
- Reliable and consistent light output enhances visibility over the life of the lamp
- FAA approved in conjunction with many OEM fixtures
- Durable construction provides resistance to the effects of vibration
- Broad product portfolio for runway, taxiway, and approach lighting
- IR radiation provides guidance in low visibility conditions
- Flicker-free operation
- Ability to reduce light output when needed
- Mercury-free

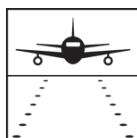

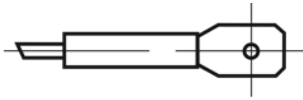

Connector C, male flat

PK30d Connector C male flat

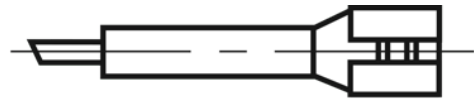

Connector A, female

PK30d Connector A female

Product family datasheet

Technical data

Product description	Electrical Data		Photometric Data	
	Nominal wattage	Nominal voltage	Nominal luminous flux	Color temperature
64319 Z/C 45-15	45 W	6.8 V	800 lm	3000 K
64317 C 45-15	45 W	6.8 V	800 lm	3000 K
64317 IRC-C 45-30	45 W	6.82 V	800 lm	3000 K
64318 A 45-15	45 W	6.8 V	800 lm	3000 K
64328 HLX-A 65-15	65 W	9.8 V	1450 lm	3050 K
64328 HLX-Z/C 65-15	65 W	9.8 V	1450 lm	3050 K
64341 HLX-A 100-15	100 W	15.2 V	2700 lm	3150 K
64341 HLX-Z/C 100-15	100 W	15.2 V	2700 lm	3150 K
64342 HLX-C 100-15	100 W	15.2 V	2700 lm	3150 K
64361 HLX-A150-15	150 W	22.7 V	3600 lm	3100 K
64361 HLX-Z/C150-15	150 W	22.7 V	3600 lm	3100 K
64382 HLX-A 200-15	200 W	30.3 V	4800 lm	3100 K
64318 Z/C 45-15	45 W	6.8 V	800 lm	3000 K
64319 A 45-15	45 W	6.8 V	800 lm	3000 K
64382 HLX-C 200-15	200 W	30.3 V	4800 lm	3100 K

Product description	Physical Attributes & Dimensions			
	Light center length (LCL)	Light center length (LCL) - (in)	Lamp base	Diameter
64319 Z/C 45-15	20.0 mm	0.787 in	PK30d	13.5 mm
64317 C 45-15	16.0 mm	0.63 in	PK30d	13.5 mm
64317 IRC-C 45-30	16.0 mm	0.63 in	PK30d	15.0 mm
64318 A 45-15	16.0 mm	0.63 in	PK30d	13.5 mm
64328 HLX-A 65-15	20.0 mm		PK30d	13.5 mm
64328 HLX-Z/C 65-15	20.0 mm	0.787 in	PK30d	13.5 mm
64341 HLX-A 100-15	20.0 mm	0.787 in	PK30d	13.5 mm
64341 HLX-Z/C 100-15	20.0 mm	0.787 in	PK30d	13.5 mm
64342 HLX-C 100-15	20.0 mm	0.787 in	PK30d	13.5 mm
64361 HLX-A150-15	20.0 mm	0.787 in	PK30d	13.5 mm
64361 HLX-Z/C150-15	20.0 mm	0.787 in	PK30d	13.5 mm
64382 HLX-A 200-15	20.0 mm	0.787 in	PK30d	13.5 mm
64318 Z/C 45-15	16.0 mm	0.63 in	PK30d	13.5 mm
64319 A 45-15	20.0 mm	0.787 in	PK30d	13.5 mm
64382 HLX-C 200-15	20.0 mm	0.787 in	PK30d	13.5 mm

Product description	Diameter (in)	Length	Length with base excl. base pins/connection	Connector: presence
64319 Z/C 45-15	0.531 in	50.0 mm	32.00 mm	Yes
64317 C 45-15	0.531 in	56.0 mm	36.00 mm	Yes

Product family datasheet

Product description	Diameter (in)	Length	Length with base excl. base pins/connection	Connector: presence
64317 IRC-C 45-30	0.591 in	48.0 mm	28.00 mm	Yes
64318 A 45-15	0.531 in	50.0 mm	30.00 mm	Yes
64328 HLX-A 65-15		48.0 mm	36.00 mm	Yes
64328 HLX-Z/C 65-15	0.531 in	48.0 mm	32.00 mm	Yes
64341 HLX-A 100-15	0.531 in	48.0 mm	35.00 mm	Yes
64341 HLX-Z/C 100-15	0.531 in	48.0 mm	35.00 mm	Yes
64342 HLX-C 100-15	0.531 in	56.0 mm	40.00 mm	Yes
64361 HLX-A150-15	0.531 in	50.0 mm	35.00 mm	Yes
64361 HLX-Z/C150-15	0.531 in	50.0 mm	35.00 mm	Yes
64382 HLX-A 200-15	0.531 in	57.0 mm	36.00 mm	Yes
64318 Z/C 45-15	0.531 in	50.0 mm	30.00 mm	Yes
64319 A 45-15	0.531 in	50.0 mm	32.00 mm	Yes
64382 HLX-C 200-15	0.531 in	57.0 mm	36.00 mm	Yes

Product description	Product weight	Operating Conditions	Lifetime Data	Environmental & Regulatory Information according Art. 33 of EU Regulation (EC) 1907/2006 (REACH)
		Burning position	Nominal lifetime	Primary article identifier
64319 Z/C 45-15	14.50 g	s90	1500 hr	4008321345578
64317 C 45-15	14.50 g	s90	1500 hr	4008321345493
64317 IRC-C 45-30	14.00 g	s90	3000 hr	4008321340139
64318 A 45-15	14.50 g	s90	1500 hr	4008321345516
64328 HLX-A 65-15	14.50 g	s90	1500 hr	4008321345592
64328 HLX-Z/C 65-15	14.50 g	s90	1500 hr	4008321345615
64341 HLX-A 100-15	14.50 g	s90	1500 hr	4008321345639
64341 HLX-Z/C 100-15	14.50 g	s90	1500 hr	4008321345653
64342 HLX-C 100-15	14.50 g	s90	1500 hr	4008321345677
64361 HLX-A150-15	14.50 g	s90	1500 hr	4008321345691
64361 HLX-Z/C150-15	14.50 g	s90	1500 hr	4008321345714
64382 HLX-A 200-15	14.50 g	s90 ¹⁾	1500 hr	4008321345738
64318 Z/C 45-15	14.50 g	s90	1500 hr	4008321345530
64319 A 45-15	14.50 g	s90	1500 hr	4008321345554
64382 HLX-C 200-15	15.60 g	s90	1500 hr	4008321345752

Product family datasheet

Product description	Declaration no. in SCIP database	Candidate list substance 1	CAS No. of substance 1	Safe use instruction
64319 Z/C 45-15	92d8f454-cc96-4495-94ef-e05e11f45f17	Lead	7439-92-1	The identification of the Candidate List substance is sufficient to allow safe use of the article.
64317 C 45-15	d9e66819-e040-4c44-bee8-4fcc5312c8c	Lead	7439-92-1	The identification of the Candidate List substance is sufficient to allow safe use of the article.
64317 IRC-C 45-30	5600ea4e-4016-4650-b994-3ad8acf8f5a0	Lead	7439-92-1	The identification of the Candidate List substance is sufficient to allow safe use of the article.
64318 A 45-15	ca26f0b4-6740-4bdb-a32d-7141568d2f95	Lead	7439-92-1	The identification of the Candidate List substance is sufficient to allow safe use of the article.
64328 HLX-A 65-15	7b45910a-859c-4e0f-92af-6a2767687bd8	Lead	7439-92-1	The identification of the Candidate List substance is sufficient to allow safe use of the article.
64328 HLX-Z/C 65-15	9ff014be-6b0f-4492-a2bc-1b13a5231d98	Lead	7439-92-1	The identification of the Candidate List substance is sufficient to allow safe use of the article.
64341 HLX-A 100-15	295ed5f7-e593-41fd-8379-aabc1761b8d4	Lead	7439-92-1	The identification of the Candidate List substance is sufficient to allow safe use of the article.
64341 HLX-Z/C 100-15	e7a8bc3b-5fc6-4418-aeba-14334908408b	Lead	7439-92-1	The identification of the Candidate List substance is sufficient to allow safe use of the article.
64342 HLX-C 100-15	df9336c6-f6aa-4cf0-a57f-d26ee6b412c0	Lead	7439-92-1	The identification of the Candidate List substance is sufficient to allow safe use of the article.

Product family datasheet

Product description	Declaration no. in SCIP database	Candidate list substance 1	CAS No. of substance 1	Safe use instruction
64361 HLX-A150-15	d0b74040-bc55-40f6-8ef2-40462d44a388	Lead	7439-92-1	The identification of the Candidate List substance is sufficient to allow safe use of the article.
64361 HLX-Z/C150-15	6c568582-5ec0-420c-8707-25bfc628d83c	Lead	7439-92-1	The identification of the Candidate List substance is sufficient to allow safe use of the article.
64382 HLX-A 200-15	bc021249-e7ad-4bcc-9af4-d2a7618c3637	Lead	7439-92-1	The identification of the Candidate List substance is sufficient to allow safe use of the article.
64318 Z/C 45-15	4a7f4d00-b3f6-4ff5-9dab-8b40cfc83462	Lead	7439-92-1	The identification of the Candidate List substance is sufficient to allow safe use of the article.
64319 A 45-15	b8092497-ad76-46a4-8f7f-7cd4786ab142	Lead	7439-92-1	The identification of the Candidate List substance is sufficient to allow safe use of the article.
64382 HLX-C 200-15	2af12407-76cf-479d-a022-f57985523da4	Lead	7439-92-1	The identification of the Candidate List substance is sufficient to allow safe use of the article.

Product description	General Product Information
	LIF code
64319 Z/C 45-15	
64317 C 45-15	J1/76
64317 IRC-C 45-30	J1/76
64318 A 45-15	J1/77
64328 HLX-A 65-15	
64328 HLX-Z/C 65-15	
64341 HLX-A 100-15	J1/79
64341 HLX-Z/C 100-15	J1/79
64342 HLX-C 100-15	J1/80
64361 HLX-A150-15	J1/83
64361 HLX-Z/C150-15	J1/83

Product family datasheet

Product description	General Product Information
	LIF code
64382 HLX-A 200-15	J1/84
64318 Z/C 45-15	J1/77
64319 A 45-15	
64382 HLX-C 200-15	J1/84

¹⁾ Despite transverse filament, can be inclined at any angle in s90 position

Product family datasheet

Safety advice

To prevent personal injury or damage to property, halogen lamps may only be operated in suitable luminaires designed with suitable mechanisms (protective shields, grids, etc.) to ensure that in the event of a lamp bursting no parts/shards can escape and that during operation no ultraviolet radiation can escape. There must also be a warning sign to indicate that the lamps give off high levels of heat. Detailed information is available on request.

Application advice

For more detailed application information and graphics please see product datasheet.

Disclaimer

Subject to change without notice. Errors and omission excepted. Always make sure to use the most recent release.